

**SET UP THEATER
PAX 300**

----- PARTITIONS

➔ EXIT

➔ SAFETY EXIT

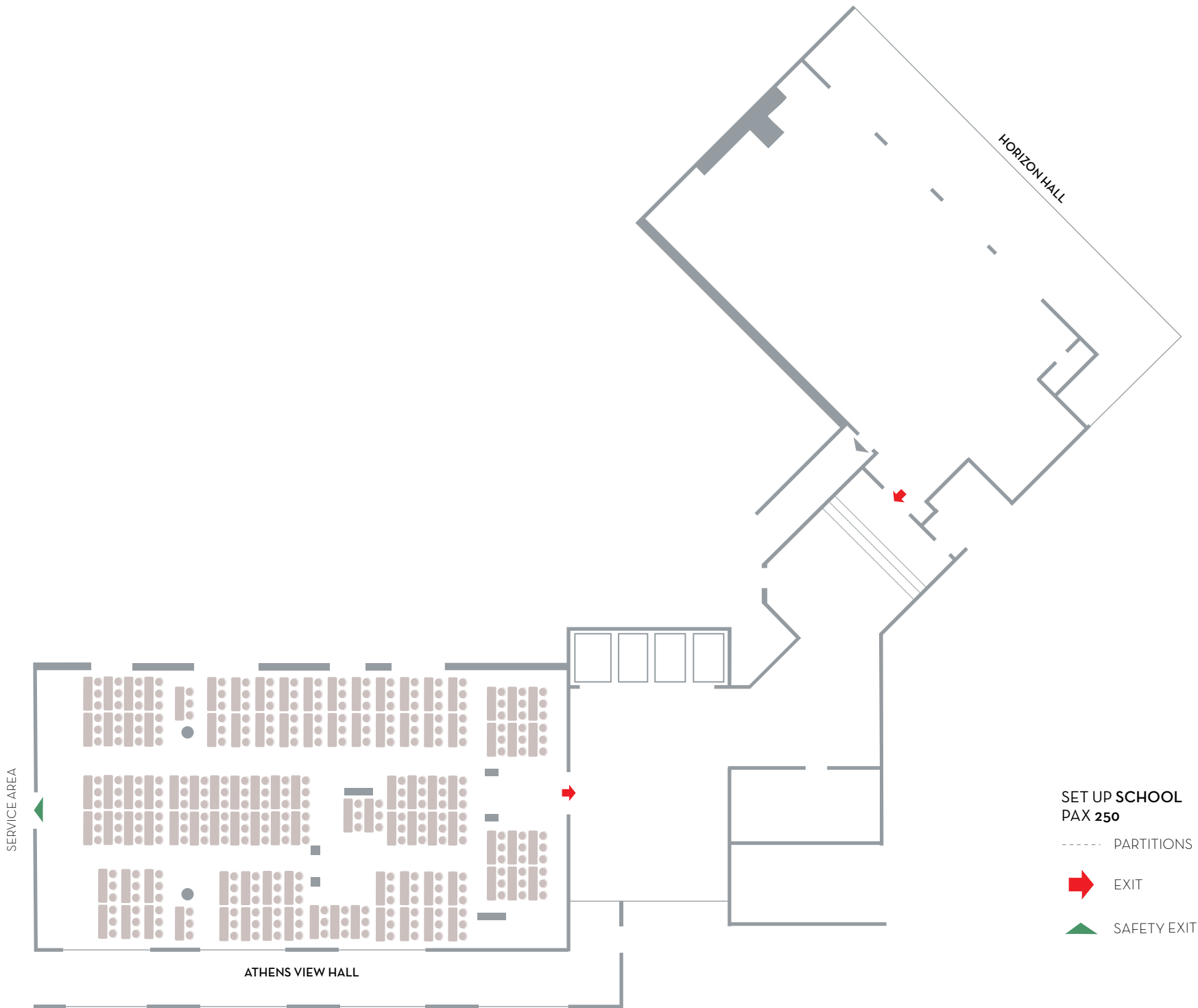

**SET UP SCHOOL
PAX 250**

- PARTITIONS
- ➡ EXIT
- ▲ SAFETY EXIT

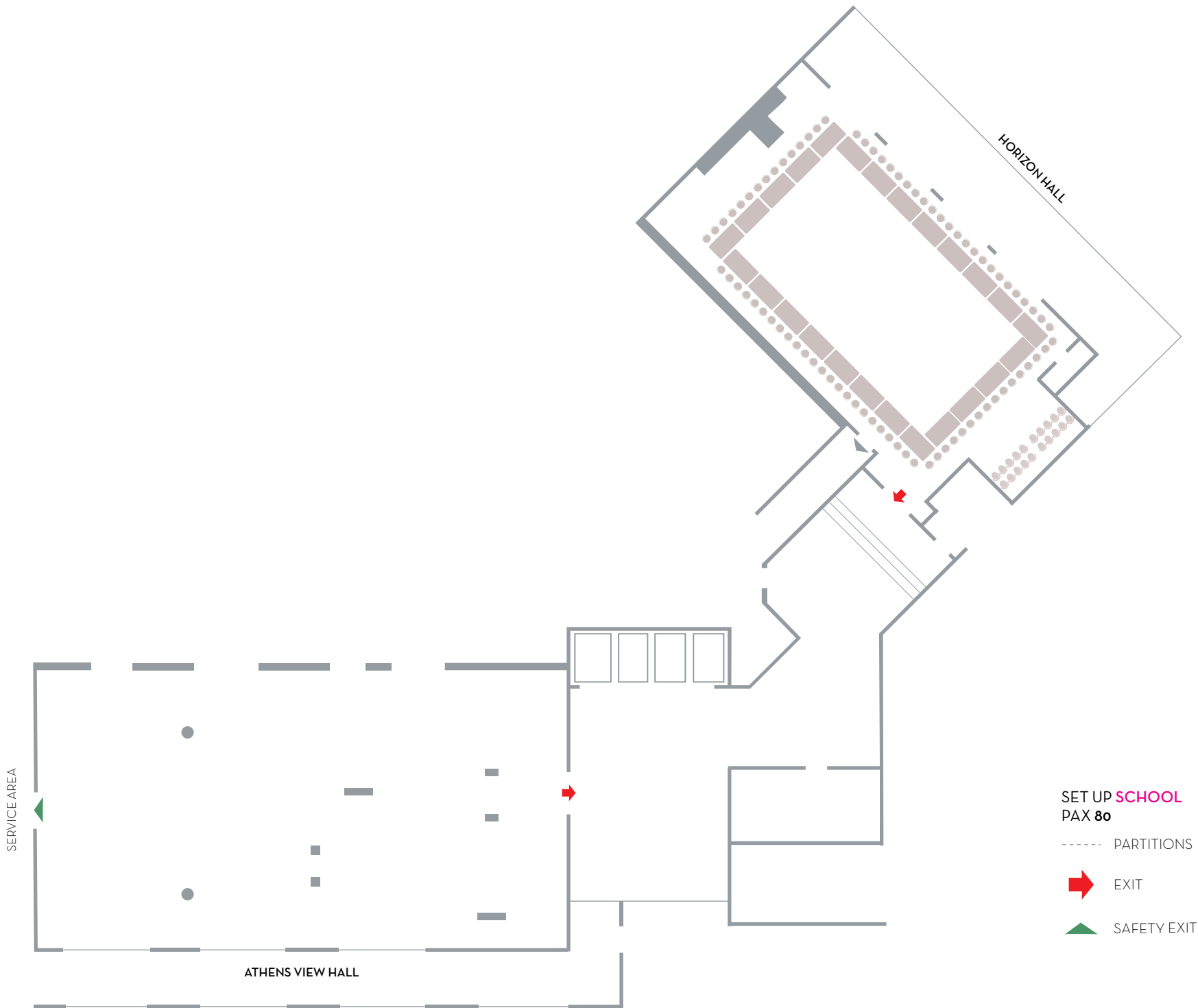

SET UP SCHOOL
PAX 80

----- PARTITIONS

➡ EXIT

▲ SAFETY EXIT

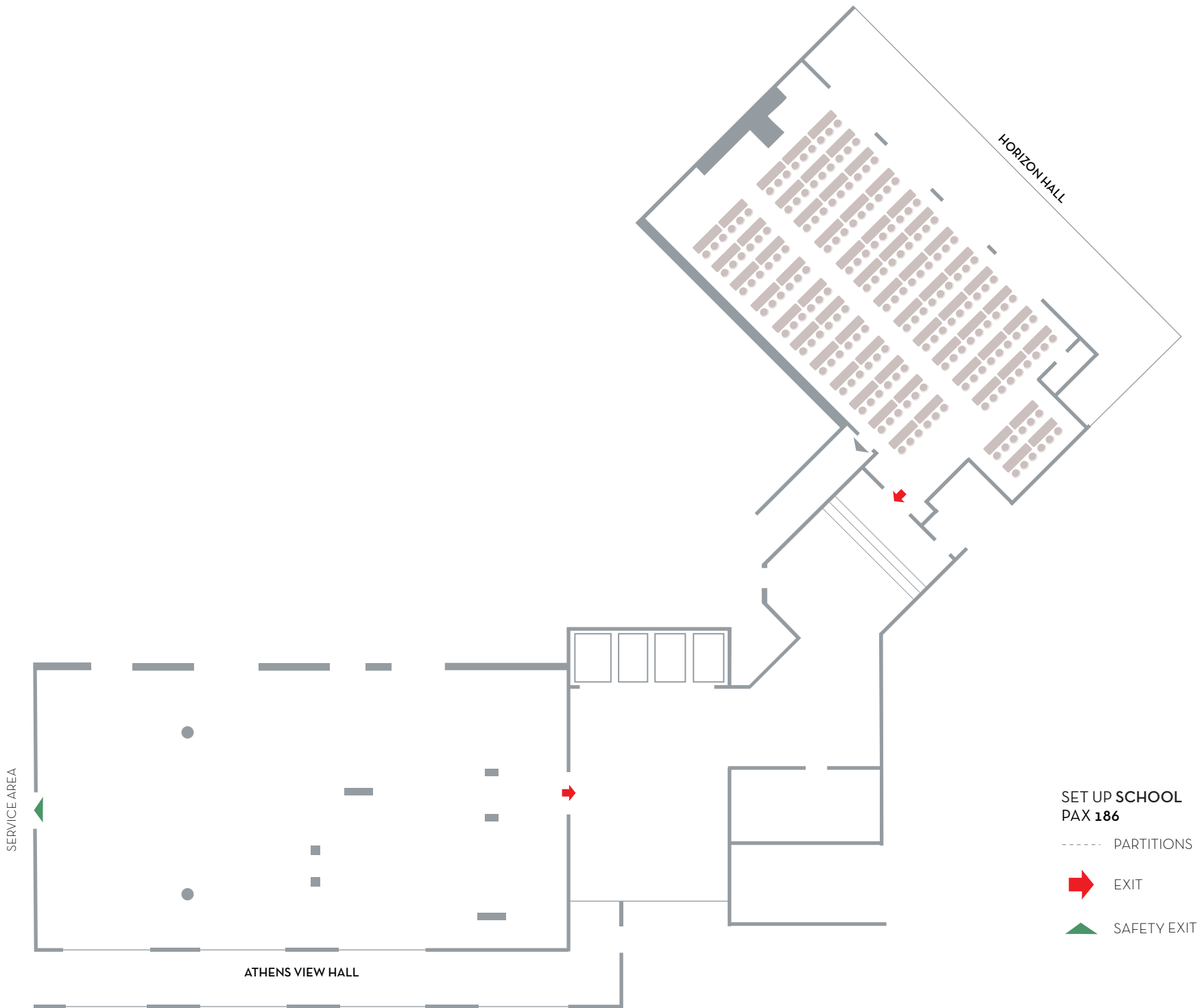

**SET UP SCHOOL
PAX 186**

----- PARTITIONS

 EXIT

 SAFETY EXIT

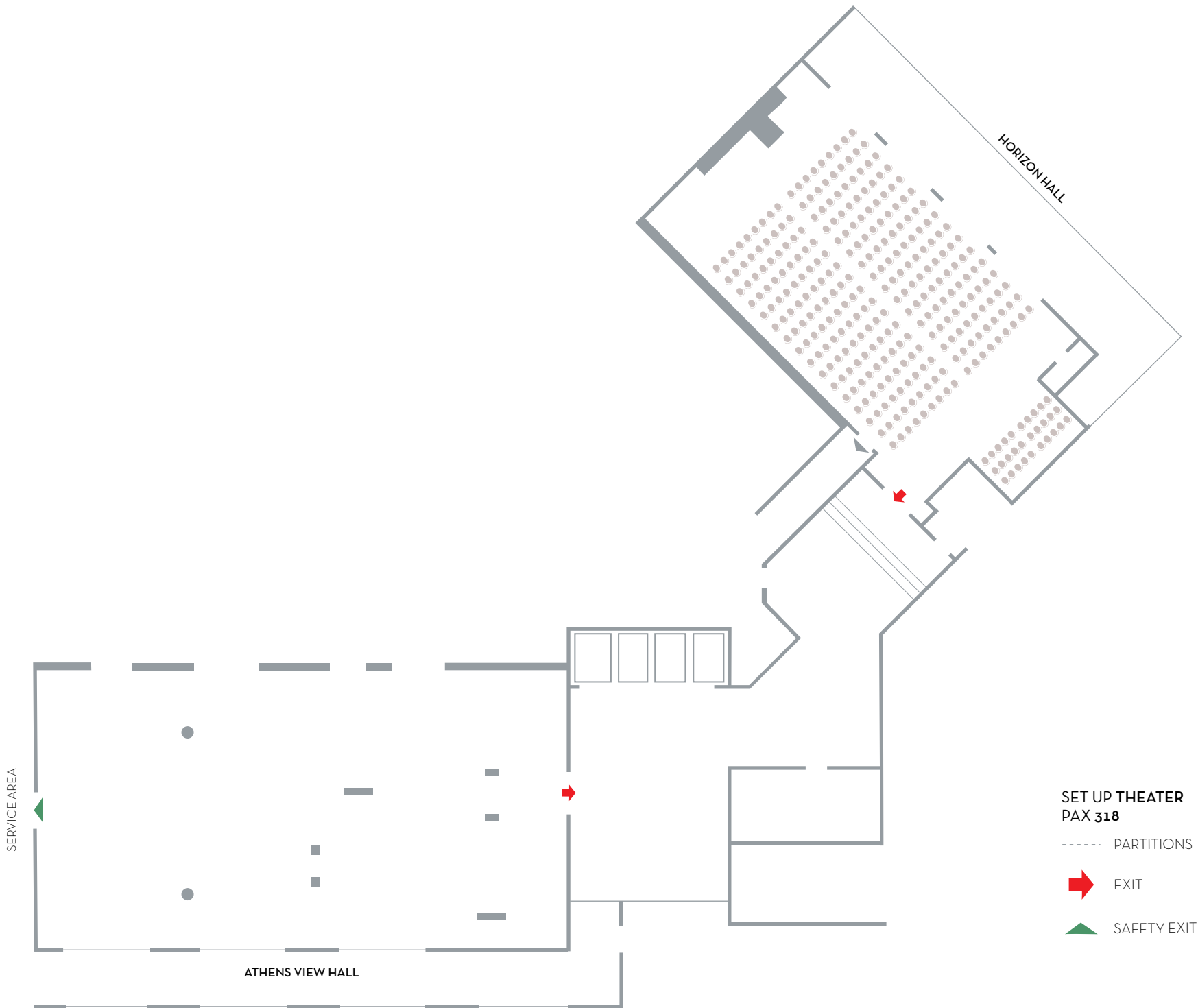

**SET UP THEATER
PAX 318**

----- PARTITIONS

 EXIT

 SAFETY EXIT

